

PRACTICA N.º 54

Ejercicios de representación de distintas piezas

A partir de las piezas representadas en perspectiva, dibujar cada una de ellas a la escala normalizada más idónea, con las vistas necesarias para su completa interpretación (figs. 54.1 a 54.48).

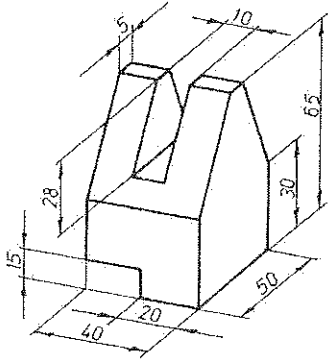

Fig. 54.1

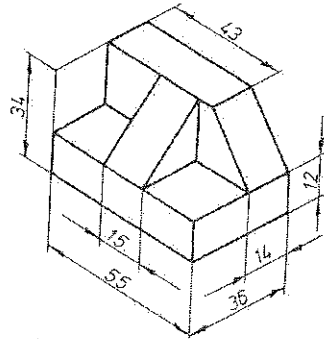

Fig. 54.2

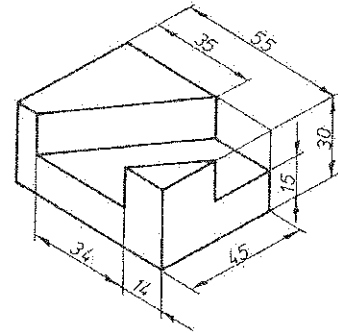

Fig. 54.3

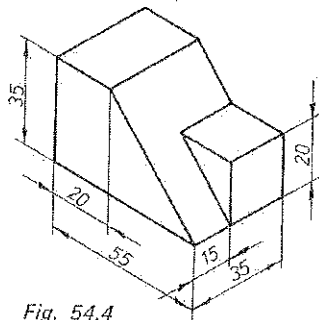

Fig. 54.4

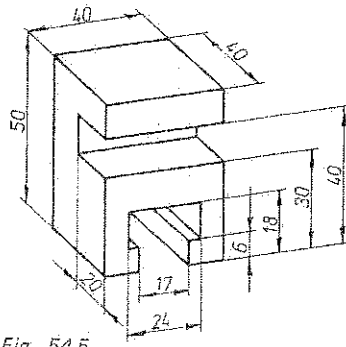

Fig. 54.5

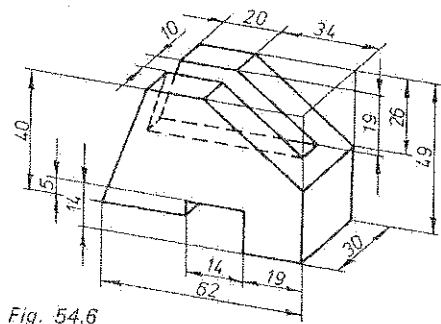

Fig. 54.6

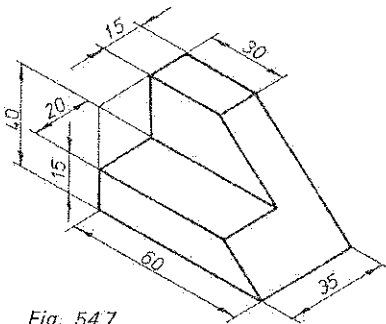

Fig. 54.7

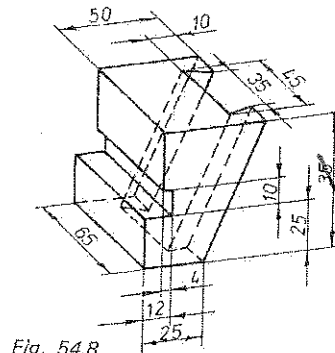

Fig. 54.8

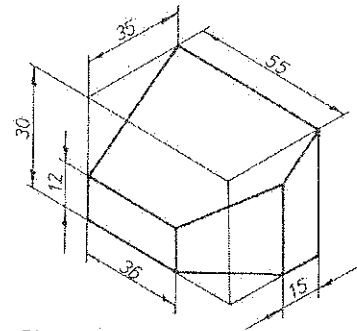

Fig. 54.9

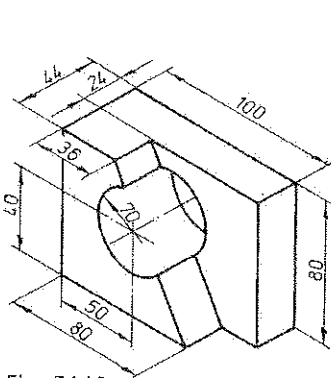

Fig. 54.10

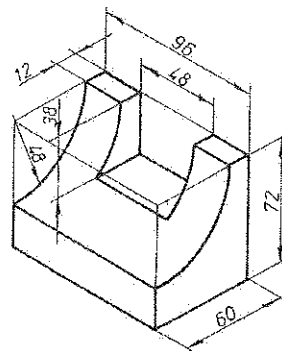

Fig. 45.11

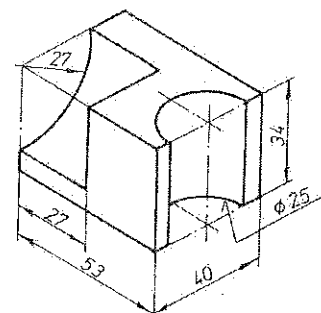

Fig. 54.12

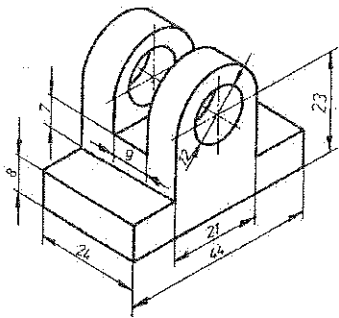

Fig. 54.37

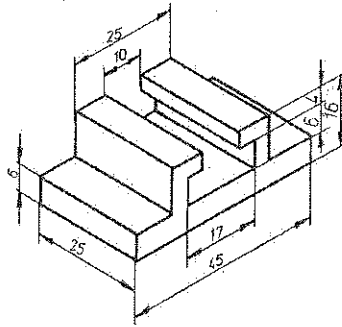

Fig. 54.38

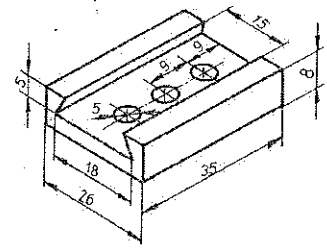

Fig. 54.39

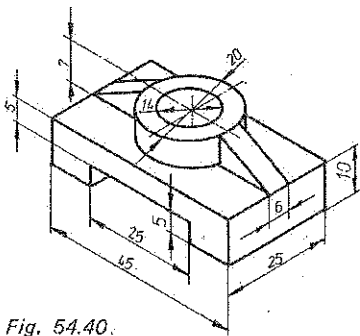

Fig. 54.40.

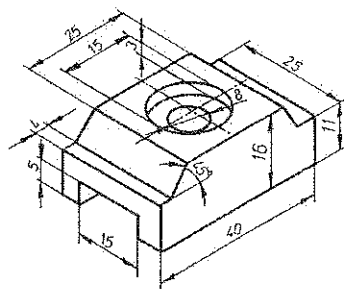

Fig. 54.41

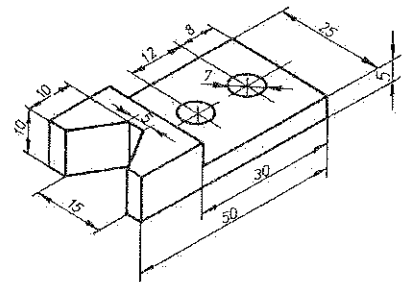

Fig. 54.42.

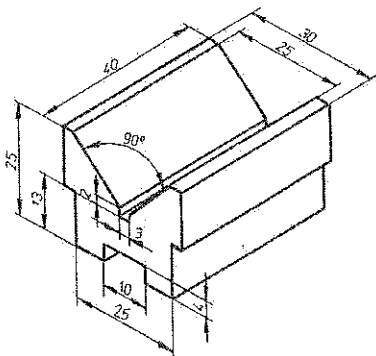

Fig. 54.43

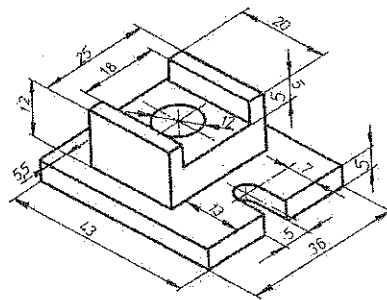

Fig. 54.44

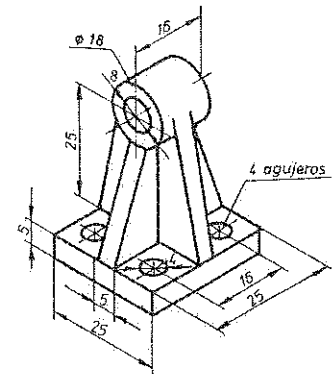

Fig. 54.45

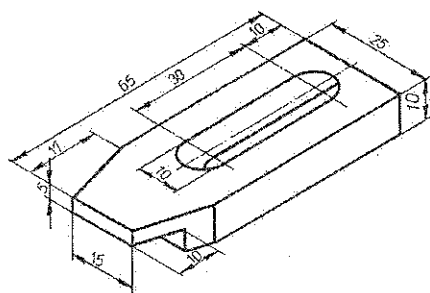

Fig. 54.46

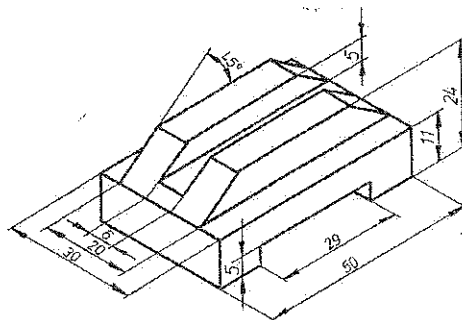

Fig. 54.47

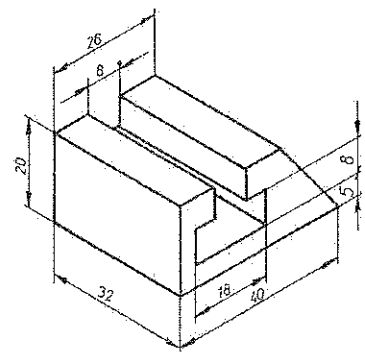

Fig. 54.48

Nota: Todos los orificios son pasantes.